

Public Notice



WRITTEN CONSULTATION MINOR EXEMPTION N° 3002169214

Notice is given to interested persons that due to the COVID-19 pandemic, the Borough council of the Borough of Pierrefonds-Roxboro has authorized, at the August 3^d, 2020 regular sitting, the replacement of the possibility for any interested person to be heard before the Council regarding a minor exemption request with a fifteen days written consultation, announced by a public notice, in accordance with ministerial order number 2020-049.

This written consultation concerns the minor exemption request for the following immovable:

Study	Place of exemption
DM 3002169214	4, rue Paquette

The exemption is to allow in H1-7-401 zone:

- A semicircle driveway located at 1.27 m from the intersection instead of the minimum of 7.5 m;
- A semicircle driveway on a lot of a width of 19 m instead of the minimum of 20 m;
- A lawn percentage of 40 % of front yard, instead of the minimum of 50 %.

The documents regarding this exemption are attached to the present public notice and available for consultation on the Borough's website: montreal.ca/pierrefonds-roxboro.

Any person wishing to submit questions or comments must do so by writing within 15 days from the date of the present publication by e-mail or by mail making sure to indicate her first name, her name and her street address at the following coordinates: greffe.pfdsrox@ville.montreal.qc.ca or Registry division, Borough of Pierrefonds-Roxboro, 13665 boulevard de Pierrefonds, Pierrefonds, Québec, H9A 2Z4.

If the application is transmitted by mail, it must absolutely be received at the above-mentioned address no later than August 22, 2020 to be considered, regardless of mailing delays.

GIVEN IN MONTREAL, BOROUGH OF PIERREFONDS-ROXBORO
this seventh day of the month of August 2020.

The secretary of the Borough

Suzanne Corbeil, Attorney

/rl

WRITTEN PUBLIC CONSULTATION

PIERREFONDS-ROXBORO BOROUGH

MINOR EXEMPTION REQUEST
AT 4, RUE PAQUETTE

AUGUST 2020

How to express your point of view on the file under study

By Mail:

You can send your written questions or comments on the current project within 15 days of the publication of the notice to the Registry Division located at 13665, boulevard de Pierrefonds à Pierrefonds Qc H9A 2Z4

By E-mail:

You can also send your questions or comments by e-mail to greffe.pfdsrox@ville.montreal.qc.ca

Projected Address:

4, rue Paquette

Pierrefonds

Lot: 6 243 917

Bois-De-Liesse District

Object of the request:

The request concerns a project to relocate a driveway as part of road repair work and the borough's By-Law requirements.

Context

- ▣ The project consists of moving the existing driveway, forming a semi-circle, in order to relocate it outside the radius of the intersection. The proposed new entrance improves safe access to the lot when compared to the existing entrance that opened directly into the intersection.
- ▣ As part of rehabilitation work on rue Paquette, the Borough has demolished a section of the existing semicircle driveway and has refused to reconstruct at the same location following the work, considering the location unsafe in regard to the position of the stop sign and the intersection.
- ▣ At the request of the Borough, the owner had to buy a piece of land from his neighbour in order to add it to his own, allowing a layout which complies with the requirements of the Borough.
- ▣ However, some details were still found to be non-compliant, making the present minor exemption request necessary in order to regularize the following elements:
To allow in zone H1-7-401, the relocation of the driveway entrance:
 - At a distance of 1.27m from the intersection instead of 7.5m minimum;
 - Authorized for a field width of 19.0m instead of 20.0m minimum;
 - Allowed a grass percentage of 40% of the front yard, instead of 50% minimum.

Location of the site



4, rue Paquette

Date: 20-07-29 14:46

Producteur: DAUSE - PFDSROX

Échelle 1:419

DWG002169214

Google Maps 4 Rue Paquette

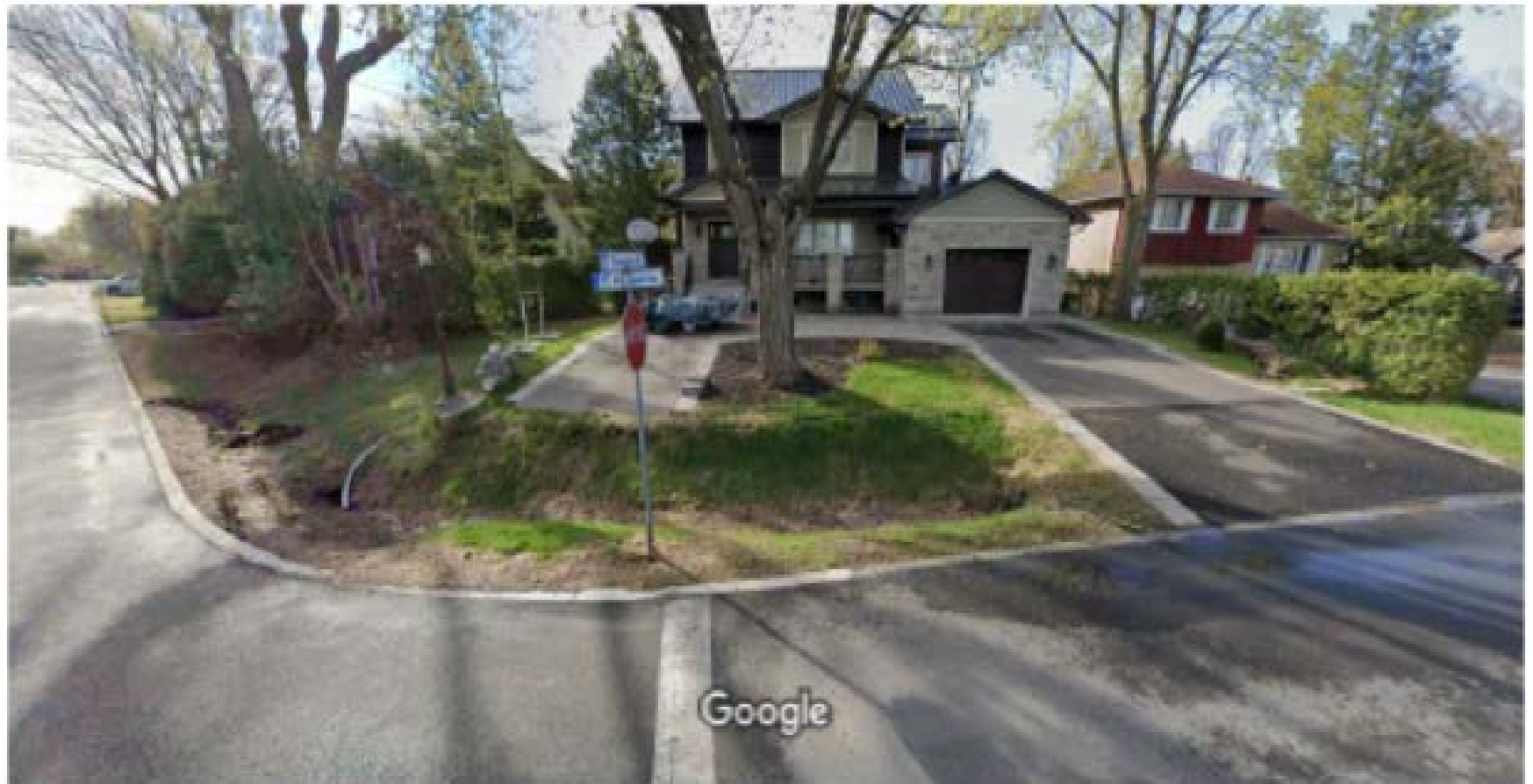

Date de l'image : mai 2019 © 2020 Google

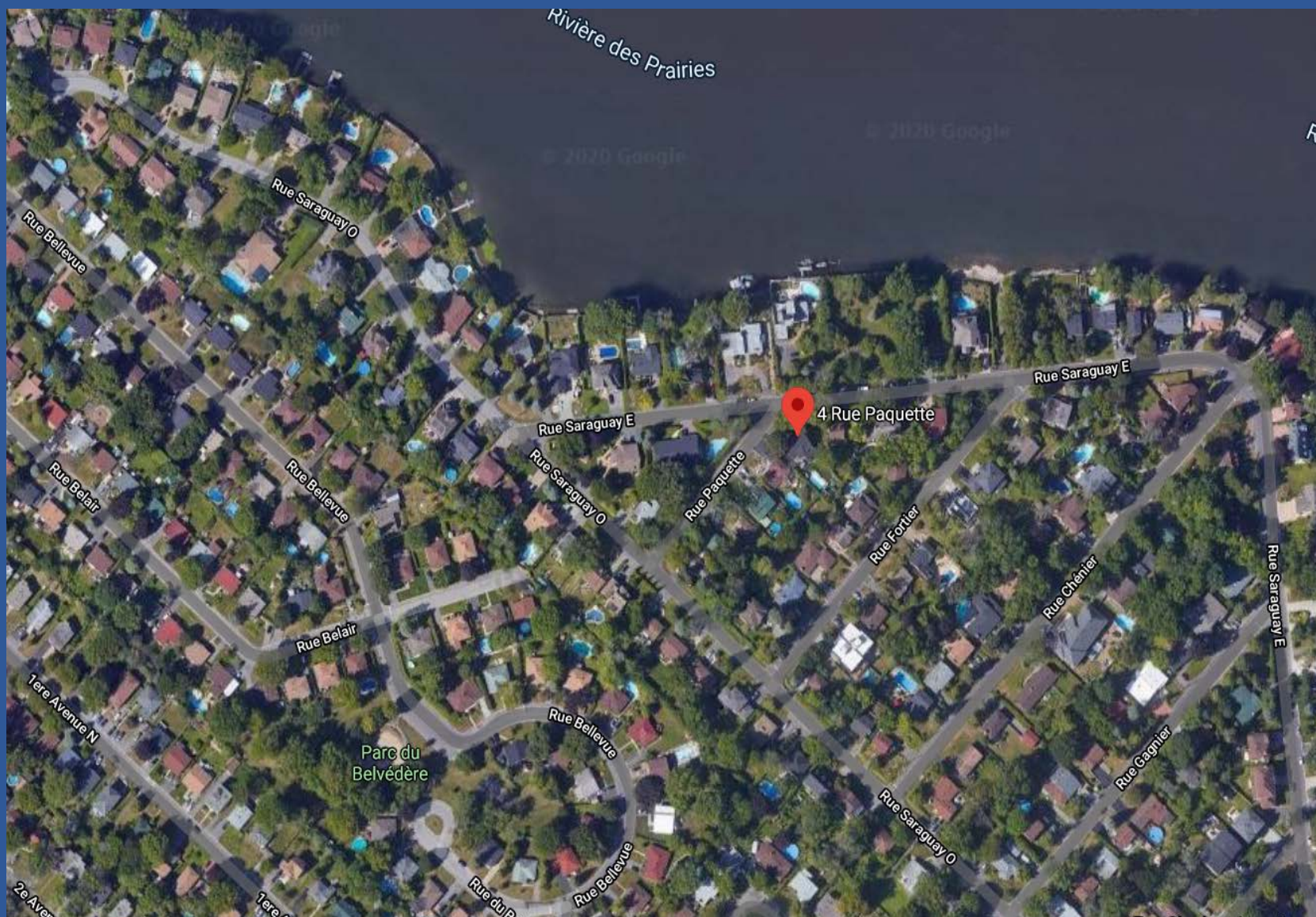

Implementation Project Plan

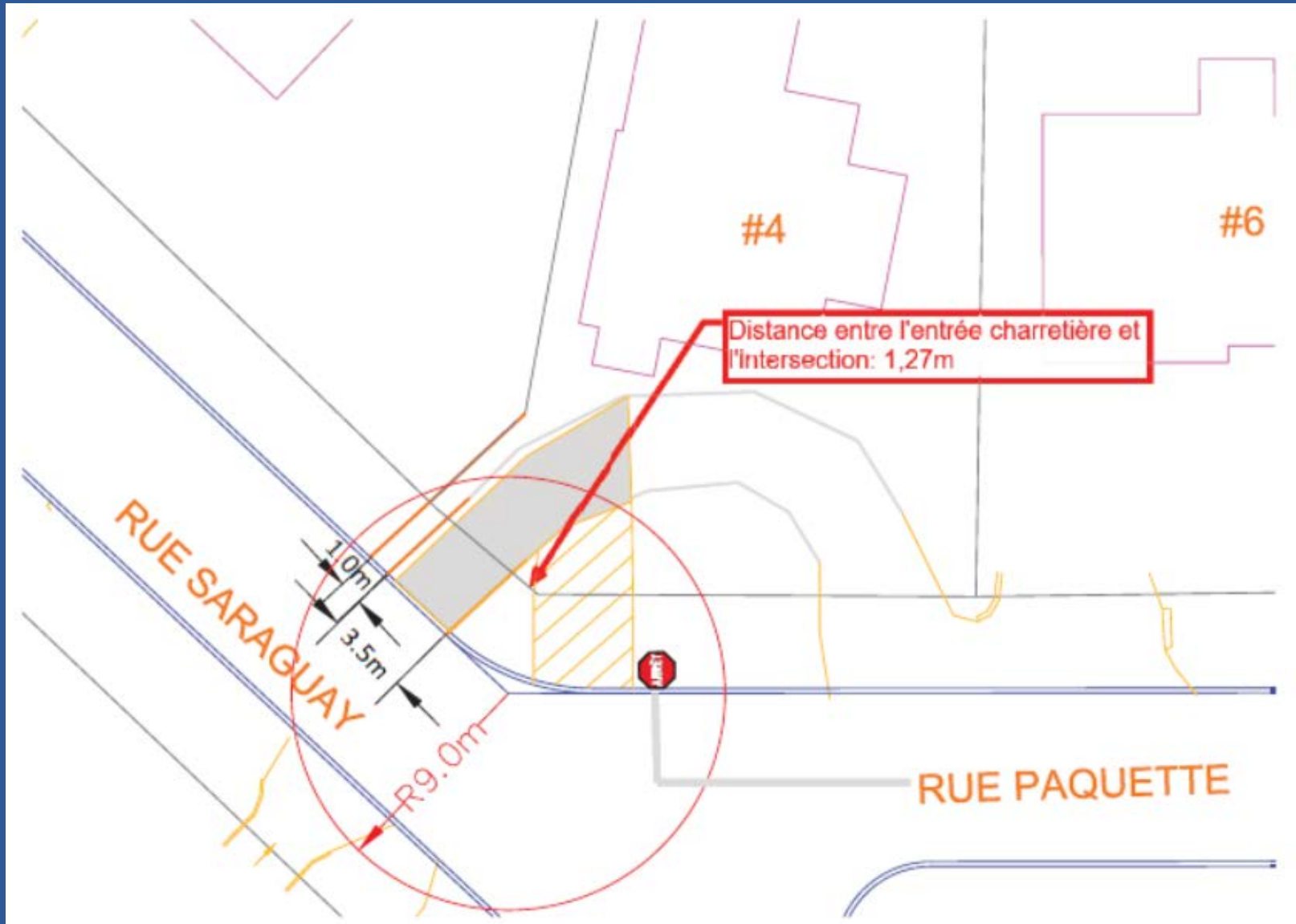

LAPELLE DU PARADE
CROUS LA MOISSE

RUE PAQUETTE
1 390 573

RUE SARAGUAY
1 380 572

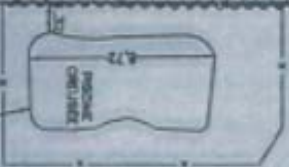
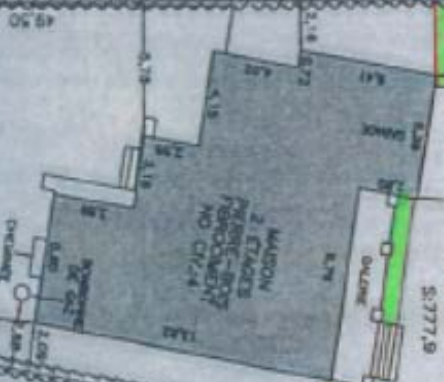

1 388 205

1 388 483

6 221 260

1 388 508

ZONE: H1-7-401